

**DETAIL A**

SCALE 1 : 2

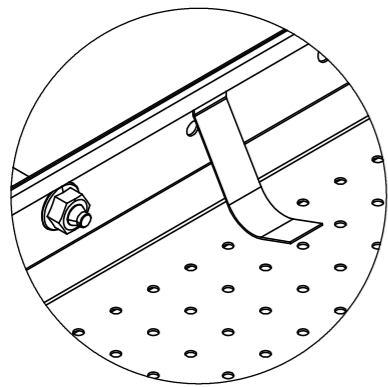

**DETAIL B**

SCALE 1 : 2

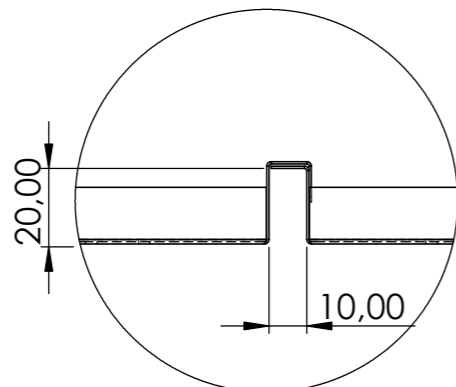

#	ITEM	Description	Qty.
1	W_CORRIDOR_GAP_290-10_L1600	CORRIDOR SYSTEM GAP 290/10	9
2	W_PL_20x40	PERIMETER TRIM "L" 40x20	2
3	W_MOLL_40x20	PANEL LOCKING SPRING FOR PERIMETER TRIM 40x20	18
4	W_EXP-BOLT_M6x30	EXPANSION BOLT M6x30	20

Material:		Part number: <b>W_CORRIDOR_GAP_290-10_L1600_AS</b>	
Finish:		Description: <b>CORRIDOR SYSTEM 300 (290 + GAP 10)</b>	
Unless Otherwise Stated: Linear Tol.: ±0.2. Angular Tol.: 0°15' Surface Finish: 0.8µm All Dimensions: mm Drawing Scale: <b>1:50</b>		Drawing code:	Drawn by: <b>mario.divalerio</b> Checked/Approved by: <b>alessio.maggi</b>
Approx Weight: Kg		Drawing Produced In Accordance With: <b>ISO 128</b>	
Projection Method: <b>FIRST ANGLE</b>		Sheet Size: <b>A3</b>	
TRE C		false ceiling systems insulating panels soundproofing cabins Via Piani dei Resinelli, 9 22036 Erba(CO) ITALY <a href="http://www.trec.it">www.trec.it</a> - <a href="mailto:info@trec.it">info@trec.it</a>	
		This drawing and any information or descriptive material set out on it are the confidential and copyright property of TRE C and MUST NOT BE DISCLOSED, COPIED, LOANED in whole or part or used for any purpose without our written permission.	
		0497/24 Sheet: <b>1 of 1</b> Revision:	